

NISSAN

GB Towbar	BG Теглич
FR Attelage	HU Vonóhorog
DE Anhängezugvorrichtung	PL Hak holowniczy
SE Dragkoppling	RO Bară de tracțiune
DK Anhængertræk	UA дишель прицепа
NL Trekhaak	SK Ťažná tyč
ES Enganche	SL Vlečni drog
IT Gancio di traino	HR Šipka za vuču
PT Gancho de reboque	GR Δοκός ρυμούλκησης
NO Dragstong	RU Буксирный крюк
IS Dráttarbeisli	AR زاوية الجر
TR Çeki demiri	IL וו גרירה
CZ Vlečná tyč	FI Vetokoukku

Part nr.: KE500-5X100

Type: 4365 Fixed

Navara (D40) With stepbumper; 05/2005 ->



Euro Approval nr. towbar: e11 00-5449

**NISSAN INTERNATIONAL S.A.
MADE IN HOLLAND**

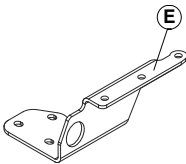
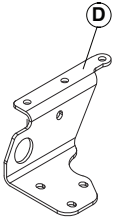
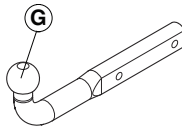
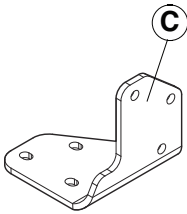
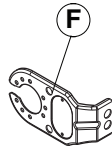
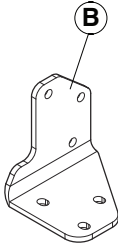
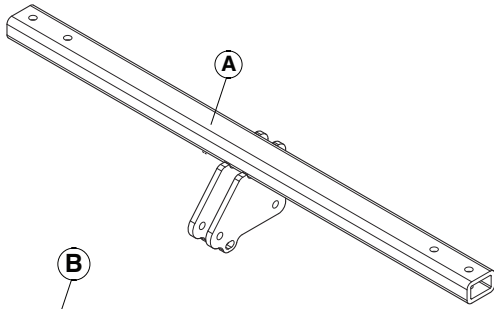

spare parts
KE500-99918



(2x) M12x40(10.9)



(10x) M12x1,25x40



(2x) M12x70(10.9)



(6x) M12x85(10.9)



(16x) M12



(10x) M12



(10x) M12(10)
self-locking



(2x) \varnothing 30x14
L= 40mm



(6x) M12

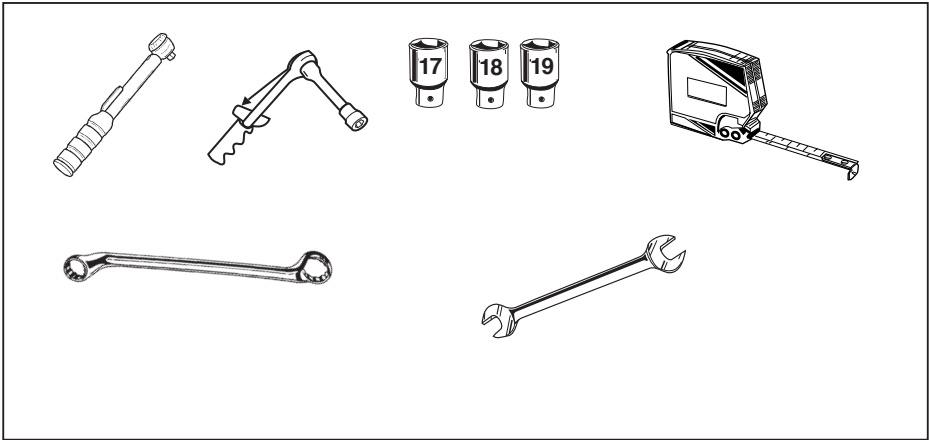

NISSAN

type nr. 4365 art. nr.

ser. nr.

coupling class

approval number

d-value

vert. load part nr.

made by **THULE**

D-value

$$D = \frac{\left(\begin{matrix} \text{K/G max} \\ \text{Car} \end{matrix} \right) \times \left(\begin{matrix} \text{K/G max} \\ \text{Trailer} \end{matrix} \right)}{\left(\begin{matrix} \text{K/G max} \\ \text{Car} \end{matrix} \right) + \left(\begin{matrix} \text{K/G max} \\ \text{Trailer} \end{matrix} \right)} \times \frac{9.81}{1000} = \boxed{15,6} \text{ kN}$$

8.8

10.9

10

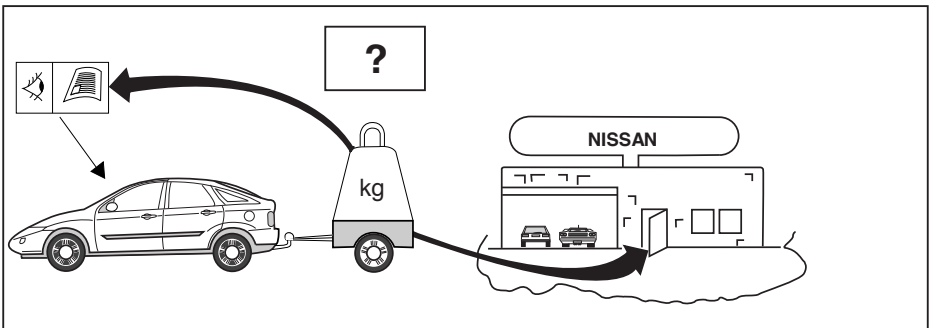



- GB:** See Workshop Manual section Body and Trim.
- FR:** Voir Manuel d'atelier section Carrosserie et draper.
- DE:** Siehe Werkstatthandbuch Bereich Unterbau/ Rahmengruppe - Ausschnitt
- SE:** Se Verkstadsmanualen under kapitlet kaross och inredning.
- DK:** Jævnfør værkstedsmanualen under 'Karosseri og beklædning'
- NL:** Zie werkplaatshandboek sectie Carrosserie & bekleding.
- ES:** Ver manual de taller sección Carrocería e Interiores.
- IT:** Consultare la sezione relativa a Carrozzeria e Interni del manuale di manutenzione.
- PT:** Consultar a secção relativa à Carroceria e Interiores do manual de manutenção
- NO:** sjå verkstadhandboka under kapitlet Karosseri og innreiing
- IS:** Sjá hlutann Yfirbygging og Snyrting í Verkstæðishandbókinni.
- TR:** Tamir Kılavuzu, Kaporta ve Döşeme bölümüne bakınız.
- CZ:** Viz Dílenská příručka, kapitola Karoserie a armatury
- BG:** Вижте в Ръководството за производство в раздел Каросерия и Салон
- HU:** Lásd a szervizkönyv Felszerelés/Karosszéria fejezetét
- PL:** Patrz: Instrukcja serwisowa, rozdział Elementy nadwozia
- RO:** Consultați secțiunea Caroserie și Interior a manualului de întreținere.
- UA:** Зверніться до посібника з обслуговування, розділ "Рама та основа кузова"
- SK:** Pozri dielenskú príručku úsek karoséria a rám
- SL:** Glej delavniški priročnik, razdelek Karoserija in šasija
- HR:** Vidi priručnik za radionicu poglavlje Karoserija i oprema
- GR:** Βλέπε Εγχειρίδιο συνεργείου, ενότητα Αμάξωμα και εσωτερική επένδυση
- RU:** См. руководство для работников гаражей, раздел «Кузов и обшивка».
- AR:** راجع كتاب الورشة، قسم المتن والبطانة
- IL:** .עיין בחוברת ההדרכה של בית המלאכה במדור "שילדה וריפוד".
- FI:** Korjaamokäsikirja, osio Kori & verhoilu.

(ONLY FOR GERMANY!)

HINWEISE:

- * Das höchstzulässige Zuggewicht und der erlaubte Kugeldruck Ihres Fahrzeugs Händler zu befragen.
- * Elektrische Anlage gemäß StVZO anbringen.
- * Diese Montage- und Betriebsanleitung ist im Fahrzeug mitzuführen und ggf. berechtigten Personen vorzulegen.

ALL COUNTRIES!
All measurements are in mm

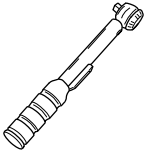

0km



+

1000km

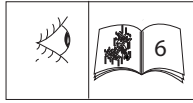

1 + 2	M12x1,25	19	100 Nm
3 + 4 + 5	M12	19	110 Nm

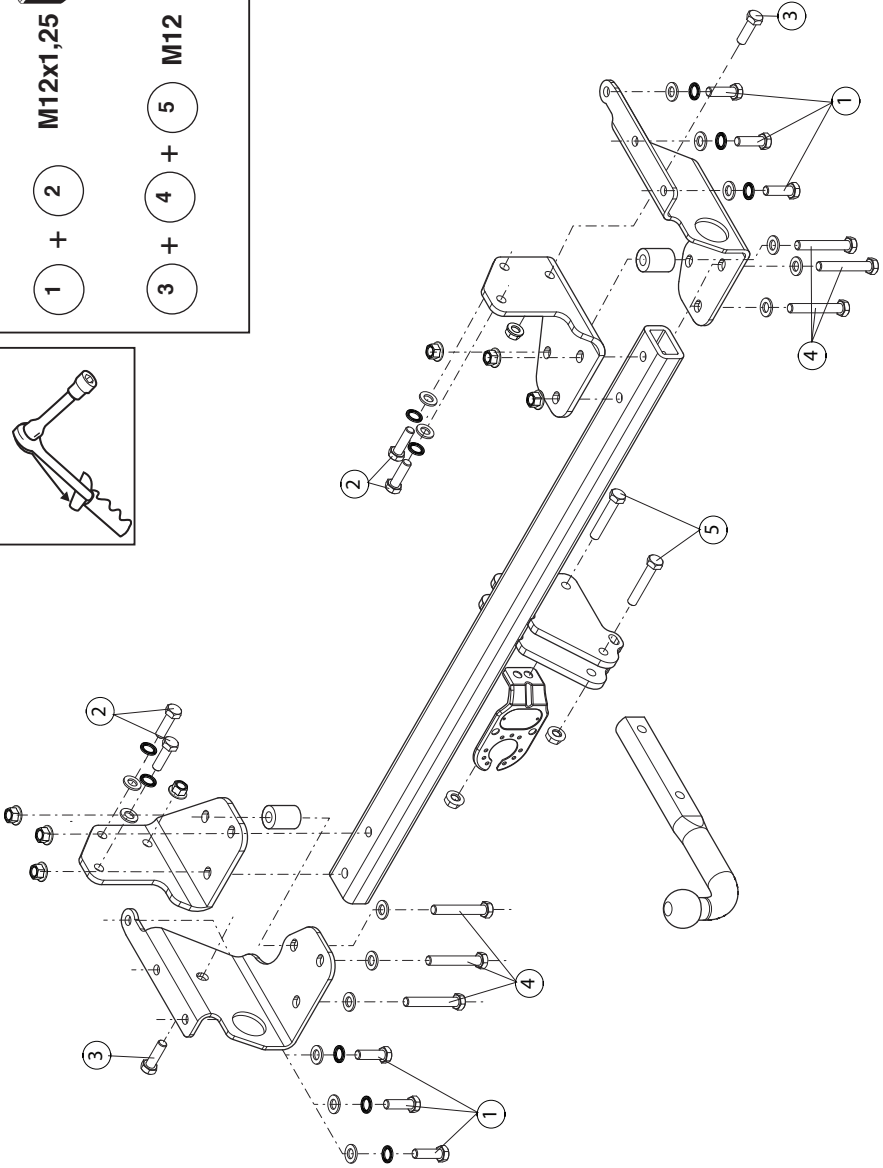
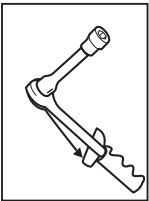

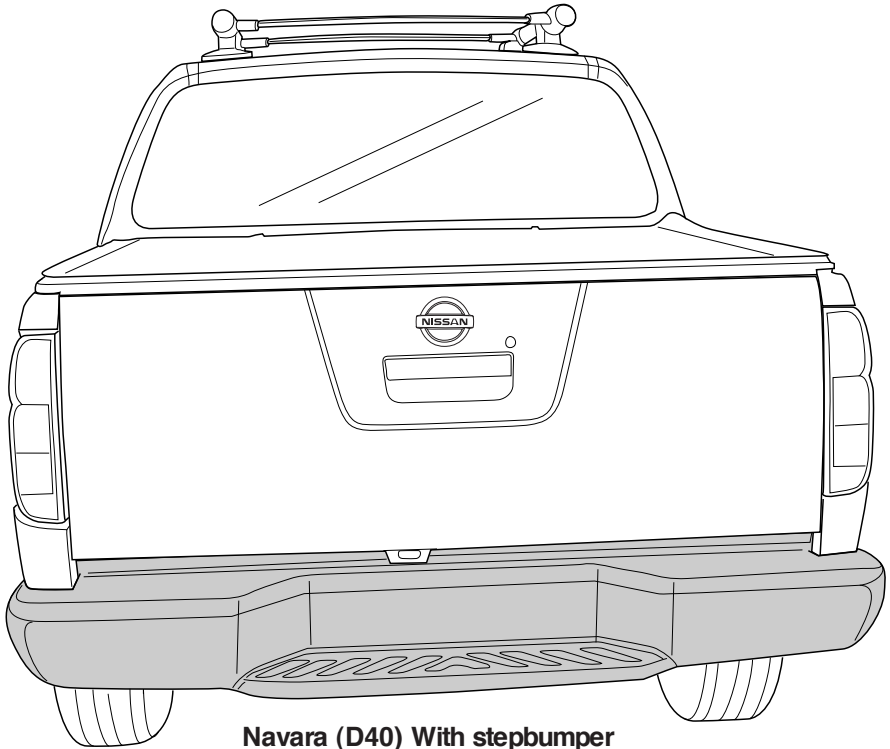

Navara (D40) With stepbumper

FIG.1

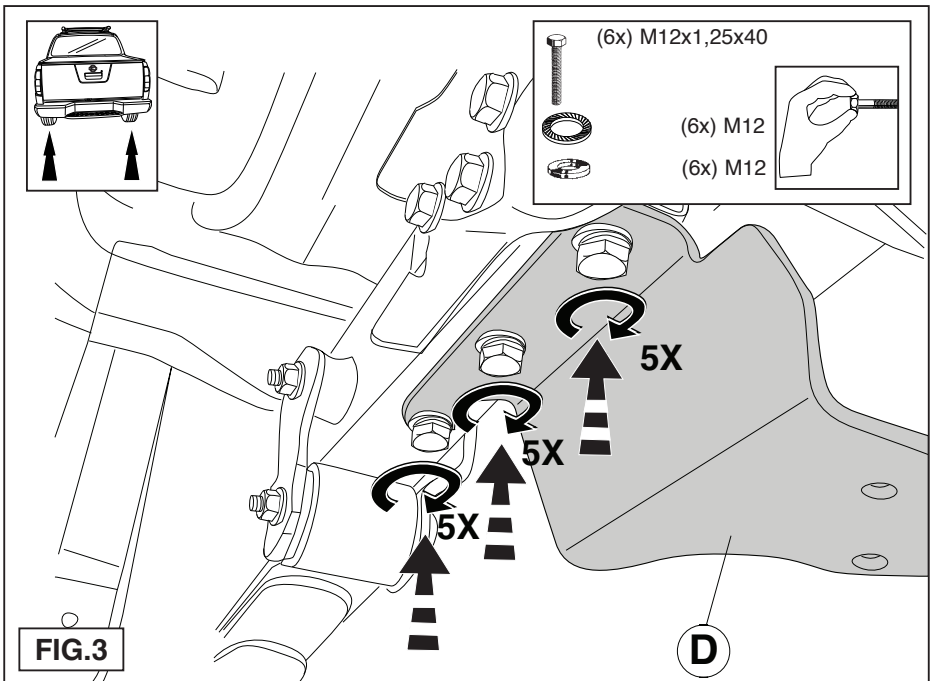
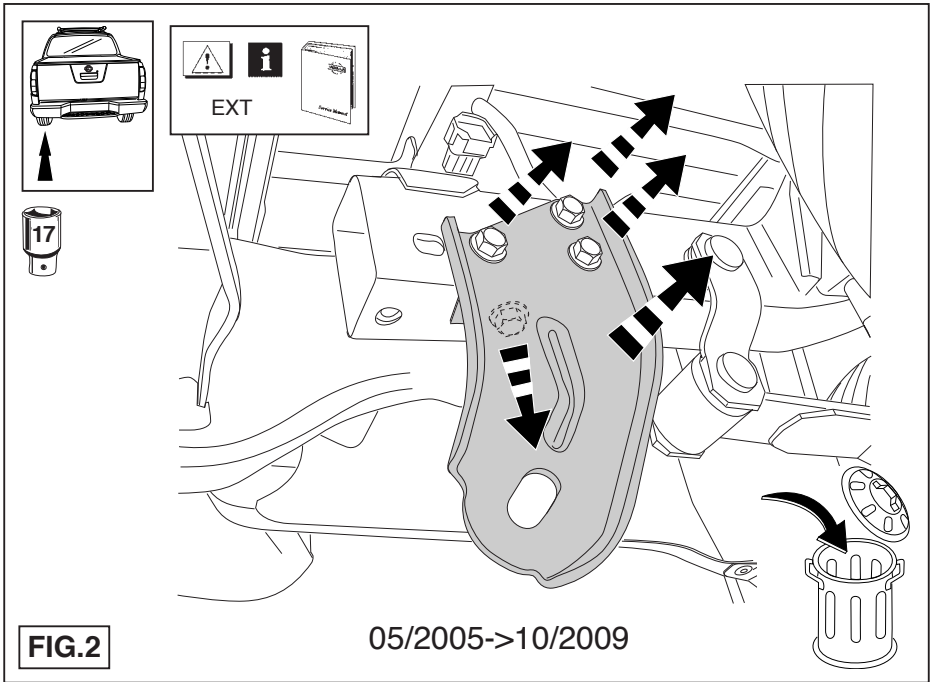

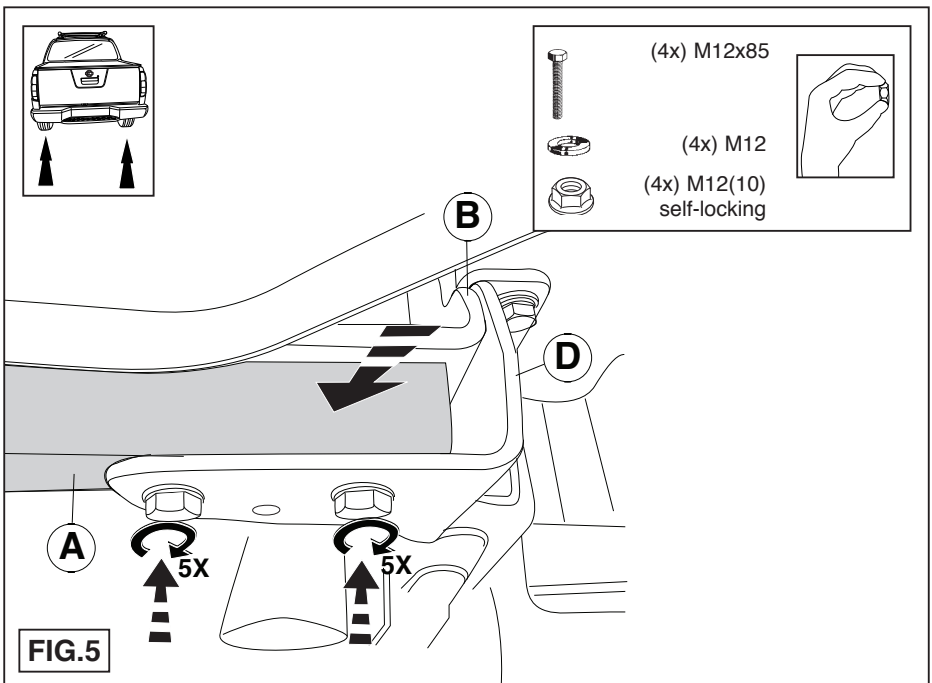
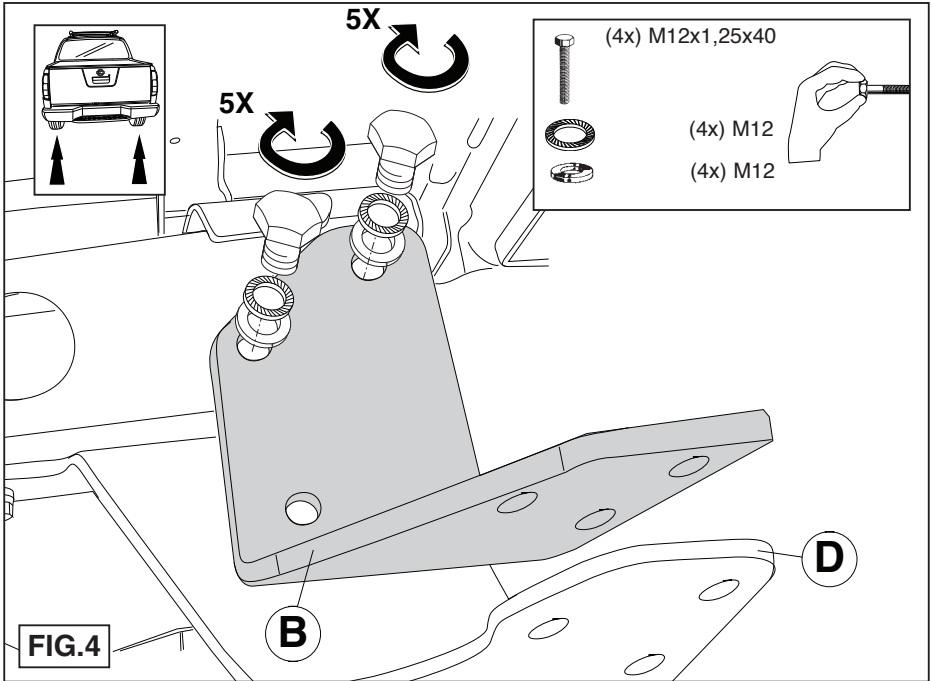

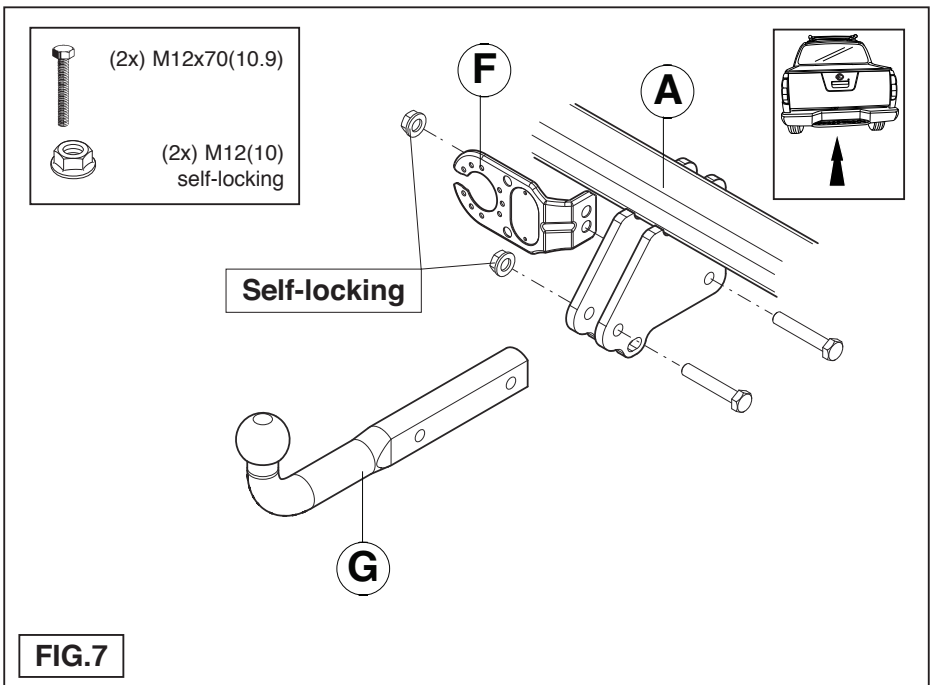
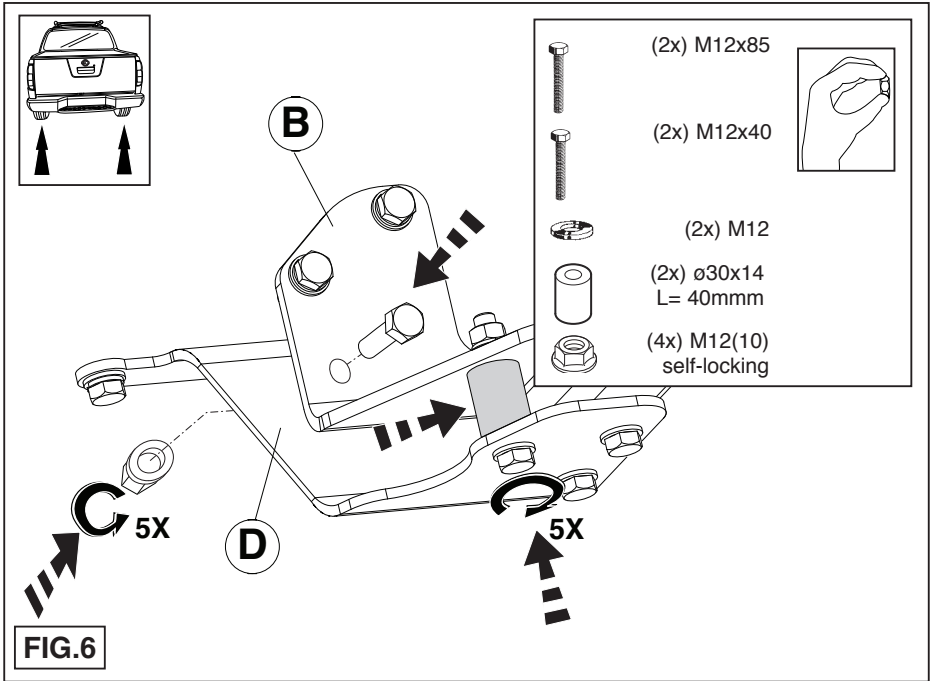

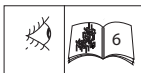

1000 Km

1 M12x1,25 19 100 Nm

2 M12x1,25 19 100 Nm

3 M12 18 19 110 Nm

4 M12 18 19 110 Nm

5 M12 18 19 110 Nm

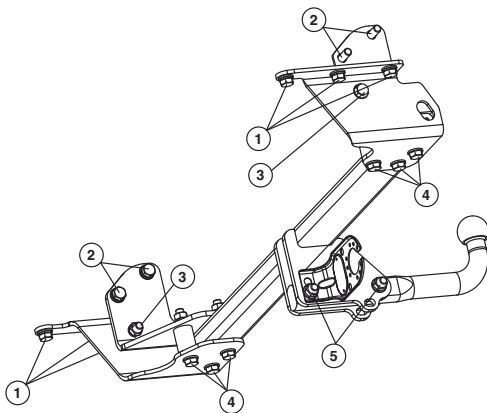

FIG.8

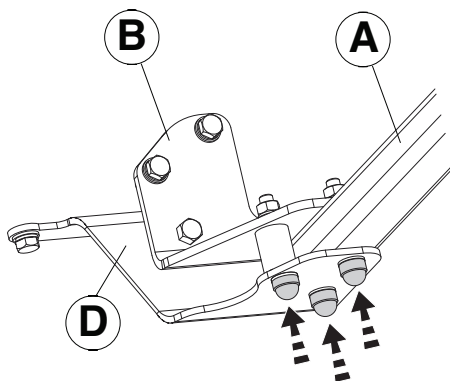
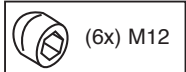
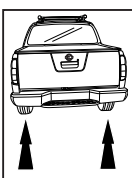

FIG.9

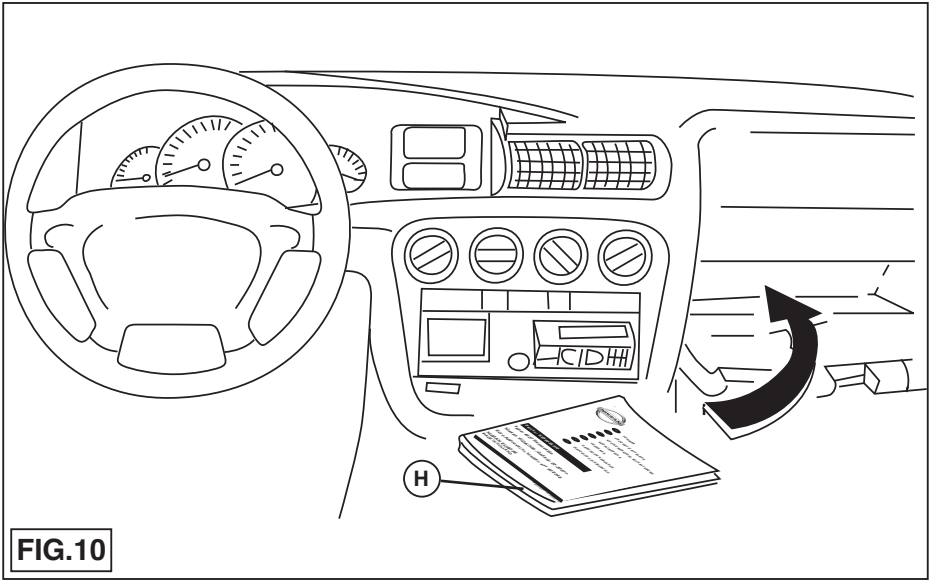

FIG.10

